



## 50 Hz Products

Commercial Duty Pumps

Heavy Duty Solids Handling Pumps

Grinder Pumps

Basin Package Assembly

Low Pressure Sewer Packages

A decorative graphic element consisting of several overlapping horizontal bars in shades of green and yellow, with a stylized 'Z' shape integrated into the design.

Trusted. Tested. Tough.®



## WHAT SETS ZOELLER PUMPS APART?

Since 1939, Zoeller Company has been manufacturing water pumps of many types. From pedestal pumps in the beginning to large HP, submersible, non-clog pumps in recent years, we have gained invaluable manufacturing experience from our humble beginning in August Zoeller's basement workshop.

Over the years, one of our most important mottos has been, 'We excel at 1,000 little things'. From start to finish, we take pride in our products. When you have residential or commercial wastewater issues, you can count on Zoeller to deliver the very best solutions. Our commitment to unsurpassed quality offers years of service and durability with a responsive and knowledgeable product support team just a phone call away.

- **MANUFACTURING IS IN OUR BLOOD...**

Rather than using a 'puzzle piece' mentality and simply buying components from other sources and assembling them, we manufacture most of our products from start to finish, continually checking the quality throughout the entire process.

Quality is always the most important element at Zoeller. Above all, quality is what has made us successful and continues to drive the decisions we make. A quality product cannot be manufactured with low-grade components. By bringing in high-quality raw castings as well as machining and powder coating the pieces in house, we are able to control the quality of each part and identify any defect throughout the manufacturing process. Each piece is subjected to numerous quality checkpoints along the way to guarantee that it is the best of the best.

- **FACTORY TESTING IS NOT JUST A BUZZWORD...**

Instead of running 'audits' on a calculated number of pumps, all submersible Zoeller pumps are 100% factory tested underwater prior to shipment. Each pump is subjected to a leak test to ensure that all gaskets, seals and mating surfaces will hold under pressure. After the pressurized leak test, the pump is powered up and run underwater to ensure that it is capable of the published head capacity and flow rate listed in our catalog and specification sheets. This testing allows us to guarantee the pump will operate out of the box every time, and you can rest assured that YOUR Zoeller pump was tested underwater for both electrical and hydraulic performance.

- **FULL BREADTH OF PRODUCT LINE...**

Zoeller is your 'one stop shop' when dealing with dewatering and wastewater systems. We offer everything from a small fractional sump pump to a large, 100 HP, non-clog pump. From battery back-ups, check valves, sewage grinder systems, small prepackaged residential units or large prepackaged municipal systems, Zoeller can offer it all. Next time you are looking for a water or wastewater system, reach for the only catalog you will ever need... Zoeller Company!

# Product Index

## COMMERCIAL DUTY PUMPS

6160, 6180 Series .....	4 - 5
6280, 6290 Series .....	4 - 5

## HEAVY DUTY SOLIDS-HANDLING PUMPS

61 HD Series .....	6 - 7
62 HD Series .....	8 - 9
64 HD Series .....	10 - 11

## GRINDER PUMPS

70 Series .....	12 - 13
7021, Progressing Cavity Grinder .....	14
71 Series .....	15 - 16

## LIFT STATION ACCESSORIES

.....	17
-------	----

## GUIDE RAIL SYSTEMS

.....	18
-------	----

# Commercial Duty Pumps

## COMMERCIAL EFFLUENT AND SEWAGE EJECTORS, 1.0 - 2.9 KW



6160, 6180 Series  
1.2 - 2.9 kW

6280, 6290 Series  
1.0 - 2.3 kW

### APPLICATIONS:

- Pump stations
- Housing developments
- Pressure sewers

### FEATURES:

- Cast iron support legs for free standing applications
- Stainless steel lifting bail
- Cast iron construction with corrosion-resistant, baked-on epoxy powder coating
- 100% computer tested

### OPTIONAL:

- Moisture sensors
- Silicon carbide seals
- Additional cord lengths available in 11 m (35') or 15 m (50')
- Single phase models available with a type E/F (5 or 10 m), G (2 or 10 m) or I (5 m) plug (except 6189 and 6294)
- CE rated models available with a 10 m (33') cord and no molded plug.

### Models 6161, 6162, 6163, 6165

Model	Mode	Volt	Ph	Amp	Motor		Weight	
					kW (p1)	Kg.	Lbs.	
V6161	Non	220	1	5.6	1.2	39	87	
AK6161	Non	380	3	2.0	1.2	39	87	
V6162	Non	220	1	8.0	1.7	39	87	
AK6162	Non	380	3	3.0	1.7	39	87	
V6163	Non	220	1	6.4	1.5	39	87	
AK6163	Non	380	3	2.9	1.5	39	87	
V6165	Non	220	3	9.6	2.0	39	87	
AK6165	Non	380	3	2.0	2.0	39	87	

### Models 6185, 6189

Model	Mode	Volt	Ph	Amp	Motor		Weight	
					kW (p1)	Kg.	Lbs.	
V6185	Non	220	1	10.0	2.0	40-43	89-94	
AK6185	Non	380	3	4.1	2.0	40-43	89-94	
V6189	Non	220	1	14.2	2.9	40-43	89-94	
AK6189	Non	380	3	4.5	2.9	40-43	89-94	

### Model 6282

Model	Mode	Volt	Ph	Amp	Motor		Weight	
					kW (p1)	Kg.	Lbs.	
V6282	Non	220	1	5.7	1.0	40	89	
AK6282	Non	380	3	1.6	1.0	40	89	

PUMP	Material	
	Pump Housing	Cast iron
	Impeller	Cast iron
	Shaft Seal	Silicon carbide/carbon lower, carbon/ceramic upper
	Seal and Gasket	Viton
	Power Cord	SOOW (H07RN for CE models)
	Design Features	
	Impeller	Non-clogging vortex
	Bearings	Ball bearing upper/lower
	Solid Passing	19 mm (3/4") spherical solids - 6160, 6180 series 50 mm (2") spherical solids - 6280, 6290 series
Power Cord Length	8 m (25') Standard	
MOTOR	Motor Housing	Cast iron
	Type	Permanent split capacitor or 3 Ph
	RPM	2800 or 1400
	Insulation Class	B; F - 6189, 6294
	Motor Protection	Auto reset thermal overload (1 Ph)
	Protection Class	IP68
Cooling	Oil filled	
Maximum Fluid Temperature	54 °C (130 °F)	
Discharge Size	1-1/2" NPT, 2" NPT, or 3" NPT- 6160, 6180 series 2" NPT, or 3" NPT- 6280, 6290 series	
Hardware	Stainless steel	

### Models 6292, 6293, 6294

Model	Mode	Volt	Ph	Amp	Motor		Weight	
					kW (p1)	Kg.	Lbs.	
V6292	Non	220	1	7.4	1.5	42-44	93-96	
AK6292	Non	380	3	3.0	1.5	42-44	93-96	
V6293	Non	220	1	8.2	1.8	42-44	93-96	
AK6293	Non	380	3	3.1	1.8	42-44	93-96	
V6294	Non	220	1	14.3	2.8	42-44	93-96	
AK6294	Non	380	3	4.7	2.8	42-44	93-96	



# Commercial Duty Pumps

## PUMP PERFORMANCE CURVES, 1.0 - 2.9 KW

### 6160 Series

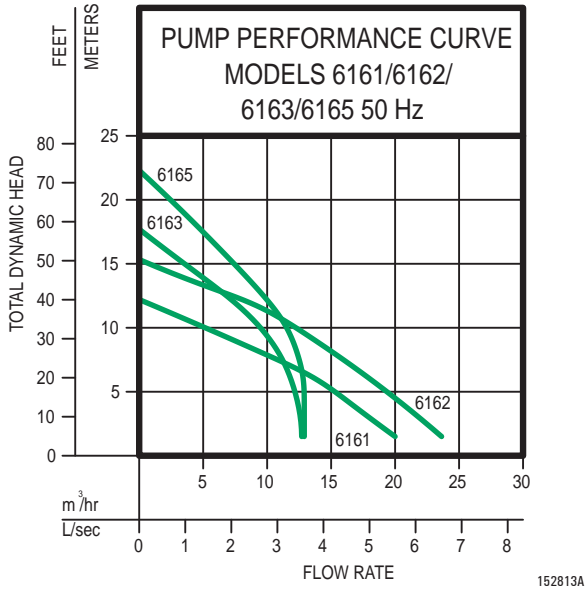

### 6180 Series

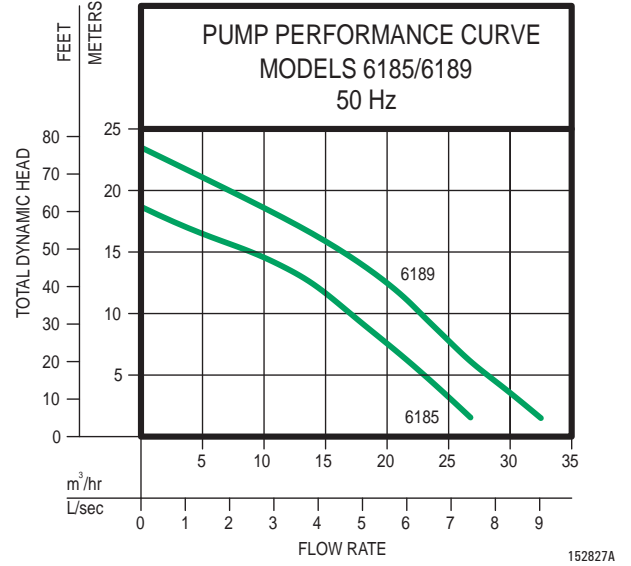

### 6280 Series

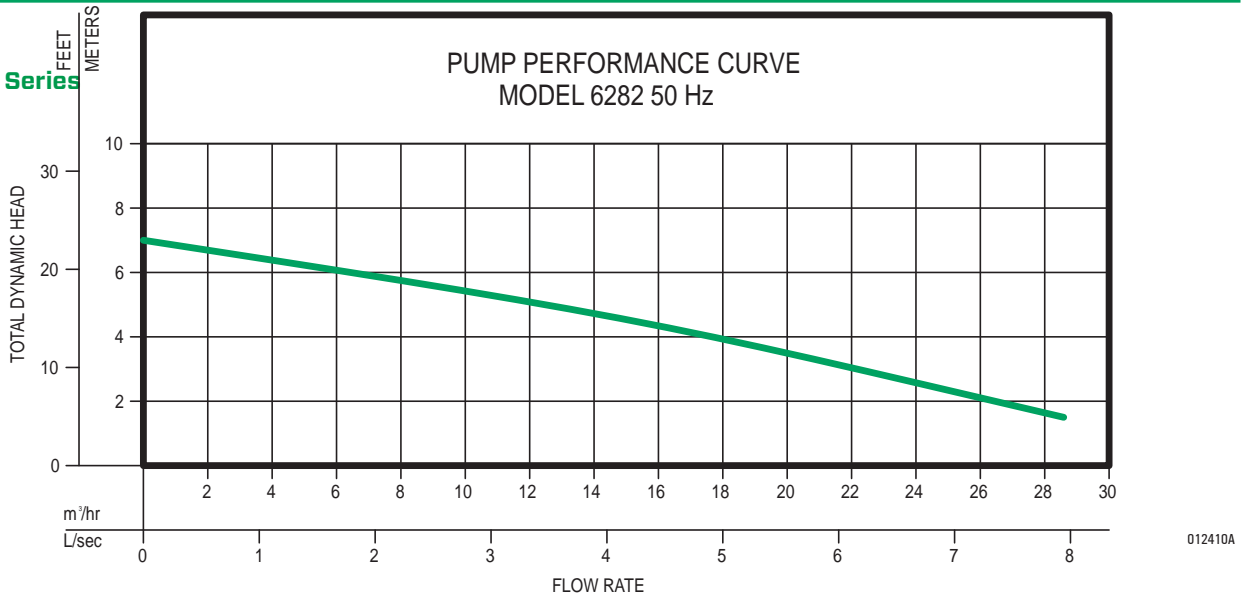

### 6290 Series

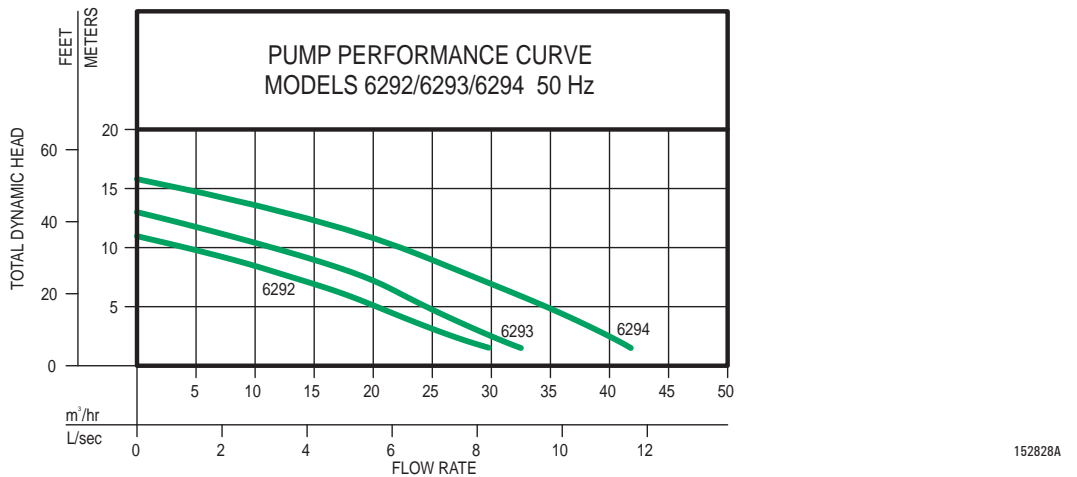

# Heavy Duty Solids-Handling Pumps

## 61 HD SERIES, 0.6 - 5.8 KW

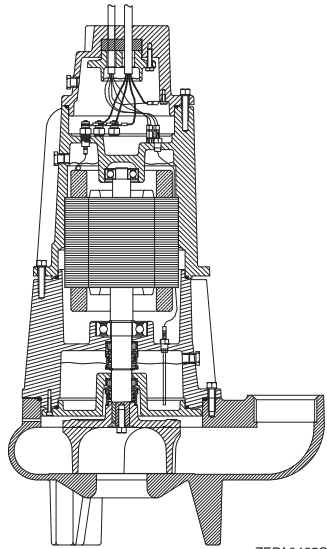

3" NPT Vertical Discharge  
0.6 - 5.8 kW

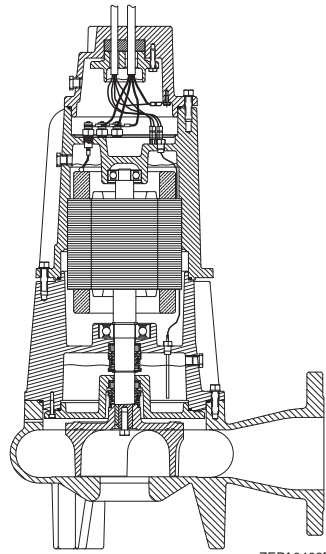

Flanged Horizontal Discharge  
3", 0.6 - 5.8 kW  
4", 0.6 - 5.8 kW

### APPLICATIONS:

- Engineered lift stations
- Storm water removal
- Wastewater transfer
- Industrial wastewater

### FEATURES:

- Cast iron construction with corrosion-resistant, baked-on epoxy powder coating
- Thermal sensor and moisture detection system with upper and lower probes
- Individually sealed conductors to eliminate cord wicking of liquids
- Lifting lug integral part of housing
- Balanced concentric pump housing and impeller

### OPTIONAL:

- Silicon carbide seal(s)
- Bronze impeller
- Vortex impeller
- Trimmed impeller
- Dry pit configuration (0.6 - 1.8 kW)
- 76 mm (3") solids capacity (4" discharge only)
- Certified tests
- Additional cord lengths available in 11 m (35') or 15 m (50')
- CE rated models available with a 10 m (33') cord

## 61 HD Series

Model	Double Seal	Mode	Volt	Ph	Amp	Motor		Weight	
						kW (p1)	Kg.	Lbs.	
AK6120		Non	380	3	1.3	0.6	111	245	
AK6121		Non	380	3	1.7	0.9	111	245	
AK6122		Non	380	3	2.7	1.2	111	245	
AK6123		Non	380	3	3.5	1.8	111	245	
AK6124		Non	380	3	5.7	2.8	111	245	
AK6125		Non	380	3	9.0	3.8	111	245	
AK6111		Non	380	3	5.4	2.7	111	245	
AK6112		Non	380	3	8.1	4.2	111	245	
AK6113		Non	380	3	10.6	5.8	111	245	

		Material	
PUMP	Pump Housing	Cast iron	
	Impeller	Ductile iron	
	Shaft Seal	Silicon carbide/carbon lower, carbon/ceramic upper	
	Seal and Gasket	Buna-N	
	Power Cord	#12-4 SO (H07RN for CE models)	
	<b>Design Features</b>		
MOTOR	Impeller	2 vane, semi-open with top pump-out vanes	
	Bearings	Ball bearing upper/lower	
	Solid Passing	64 mm (2-1/2") spherical solids	
	Power Cord Length	7.62 m (25') standard (10 m [33'] on CE models)	
	Motor Housing	Cast iron	
	Type	3 Ph	
	RPM	1400 or 2800	
	Insulation Class	F	
Motor Protection		Thermal sensor with automatic reset	
Protection Class		IP68	
Cooling		Oil filled	
Maximum Fluid Temperature		40 °C (104 °F)	
Discharge Size		3" vertical or 3" or 4" horizontal flanged	
Hardware		Stainless steel	



# Heavy Duty Solids-Handling Pumps

## PUMP PERFORMANCE CURVES, 0.6 - 5.8 KW

**61 HD Series**  
**3" NPT Vertical, 3" and 4" Horizontal Flanged**  
**Discharge**  
**semi-open impeller**

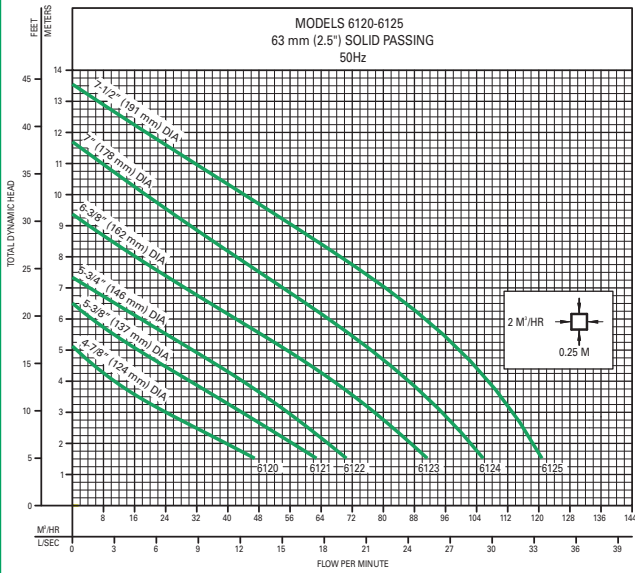

A00500B

**61 HD Series**  
**3" NPT Vertical, 3" and**  
**4" Horizontal Flanged Discharge**  
**semi-open impeller**

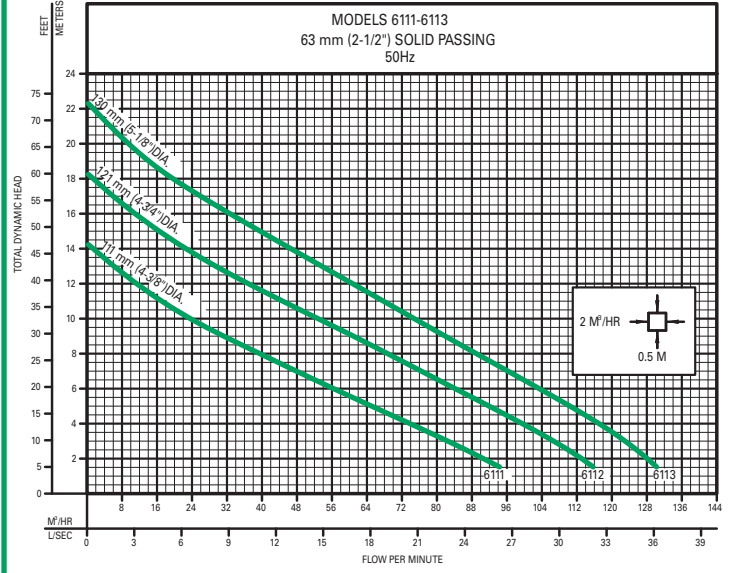

A00521B

**61 HD Series**  
**4" horizontal discharge**  
**semi-open impeller**

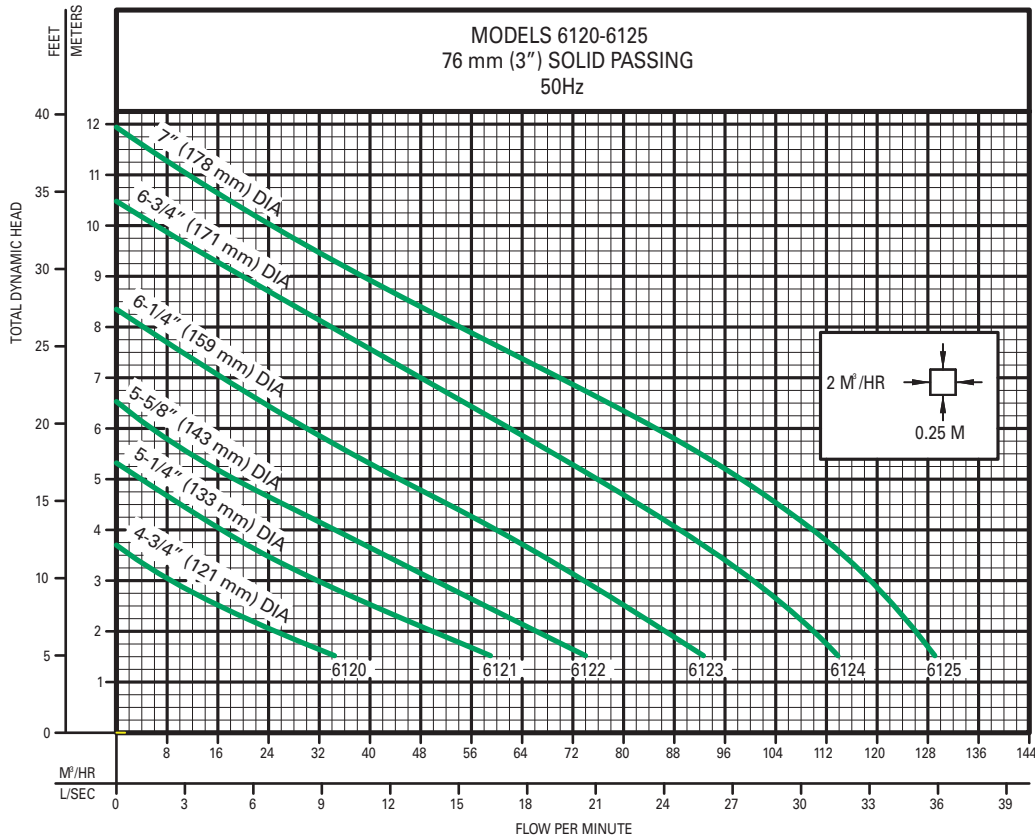

A00520B

# Heavy Duty Solids-Handling Pumps

## 62 HD SERIES, 2.8 - 10.0 KW

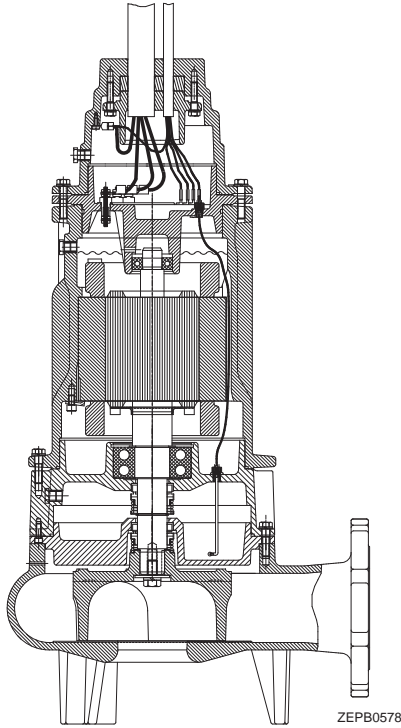

Flanged Horizontal Discharge  
4", 2.8 - 10.0 kW  
6", 2.8 - 10.0 kW

### APPLICATIONS:

- Engineered lift stations
- Storm water removal
- Wastewater transfer
- Industrial wastewater

### FEATURES:

- Protected cable entrance with compression grommet that allows for field replacement of cable
- Moisture-detection system with upper and lower probes
- Individually sealed conductors to eliminate cord wicking of liquids
- Lifting lug integral part of housing
- Cast iron construction with corrosion-resistant, baked-on epoxy powder coating

### OPTIONAL:

- Silicon carbide seals
- Bronze impeller
- Vortex impeller
- Trimmed impeller
- Dry pit configuration
- High head unit (models 6222, 6223, 6224 - available with 4" discharge)
- 6" discharge
- Additional cord lengths available in 11 m (35') or 15 m (50')
- CE models include a 10 m (33') cord

## 62 HD Series

Model	Double Seal	Mode	Volt	Ph	Amp	Motor		Weight	
						kW (p1)	Kg.	Lbs.	
AK6220		Non	380	3	5.3	2.8	159	350	
AK6221		Non	380	3	9.5	4.6	159	350	
AK6222		Non	380	3	11.0	5.4	159	350	
AK6223		Non	380	3	14.7	8.0	159	350	
AK6224		Non	380	3	18.0	10	159	350	

	Material	
	PUMP	Pump Housing
Impeller		Ductile iron
Shaft Seal		Silicon carbide/carbon lower, carbon/ceramic upper
Seal and Gasket		Buna-N
Power Cord		SOOW for Models 6220-6222, 6223-6224 (H07RN-F4G4 for CE models)
Design Features		
Impeller		2 vane, semi-open with top pump-out vanes
Bearings		Ball bearing upper/lower
Solid Passing		75 mm (3") spherical solids
Power Cord Length		8 m (25') standard
MOTOR	Motor Housing	Cast iron
	Type	3 Ph
	RPM	1400
	Insulation Class	F
	Motor Protection	Thermal sensor with automatic reset
	Protection Class	IP68
	Cooling	Oil filled
<b>Maximum Fluid Temperature</b>		40 °C (104 °F)
<b>Discharge Size</b>		4" & 6" horizontal flanged
<b>Hardware</b>		Stainless steel





# Heavy Duty Solids-Handling Pumps

## PUMP PERFORMANCE CURVES, 2.8 - 10.0 KW

**62 HD Series**  
**4" and 6"**  
**flanged discharge**  
**semi-open impeller**

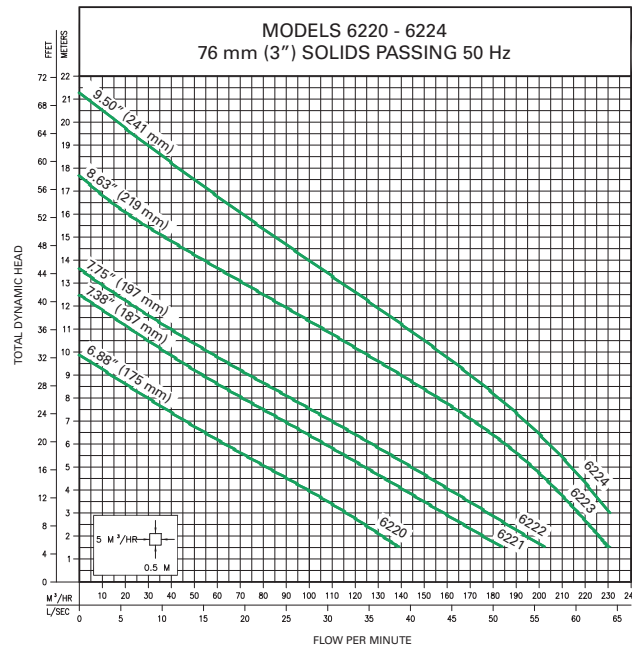

A00618

**62 HD Series**  
**4" flanged discharge**  
**high head**  
**semi-open impeller**

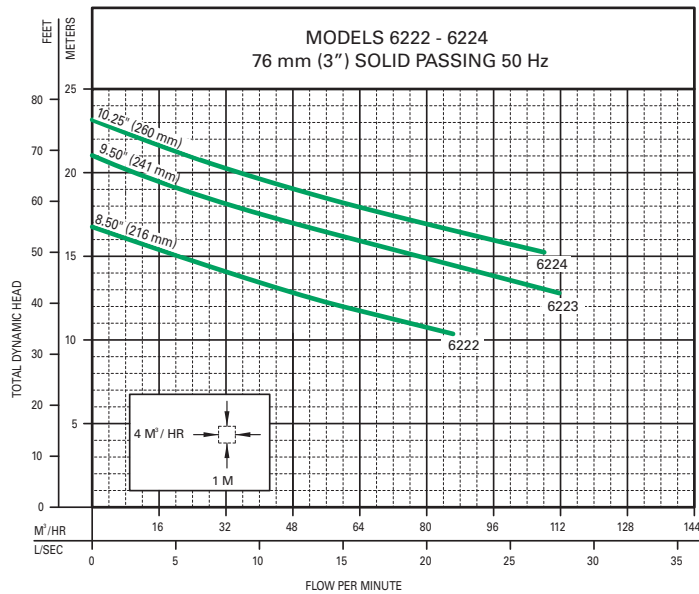

A00619

**62 HD Series**  
**4" and 6" flanged discharge**  
**vortex impeller**

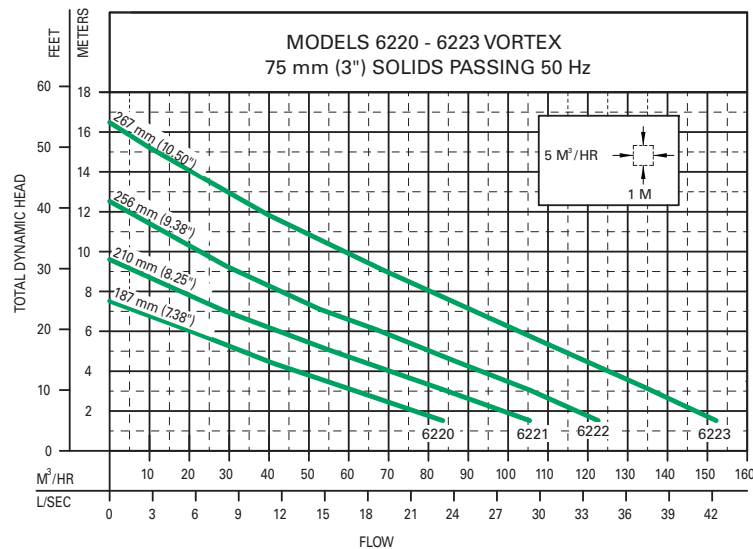

B00617

# Heavy Duty Solids-Handling Pumps

## 64 HD SERIES, 13.6 - 28.6 KW

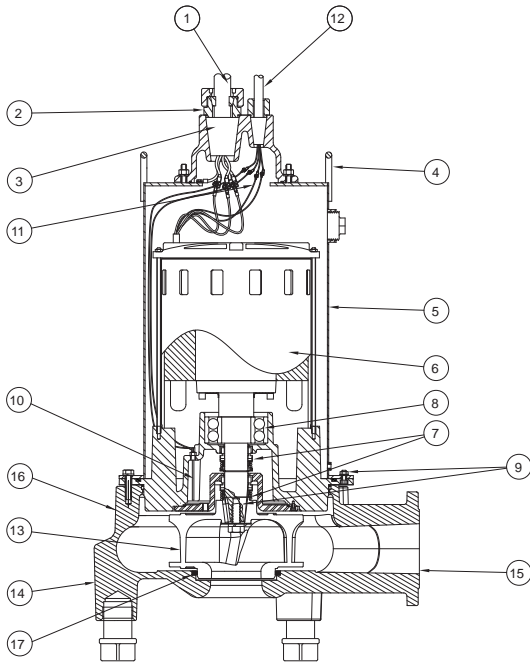

Flanged Horizontal Discharge  
4", High Head  
6", High Flow

SK3140

### APPLICATIONS:

- Engineered lift stations
- Storm water removal
- Wastewater transfer
- Industrial wastewater

### FEATURES:

- Moisture detection system
- Individually sealed conductors eliminate cord wicking of liquids
- Lifting lug integral part of housing
- Balanced concentric pump housing, enclosed 2 vane impeller with top and bottom pump-out vanes

### OPTIONAL:

- Trimmed impeller
- Additional cord lengths available
- Silicon carbide seals
- Certified tests

### 64 HD Series

Model	Mode	Volt	Ph	Amp	Motor		Weight	
					kW (p1)	Kg.	Lbs.	
AK6424	Non	380	3	25.0	13.6	374	825	
AK6425	Non	380	3	31.0	17.2	374	825	
AK6426	Non	380	3	38.0	20.9	374	825	
AK6427	Non	380	3	45.0	25.5	374	825	
AK6428	Non	380	3	50.0	28.6	374	825	

		Material		
PUMP	Pump Housing	Cast Iron		
	Impeller	Ductile Iron		
	Shaft Seal	Carbon ceramic		
	Seal and Gasket	Buna N		
	Power Cord	2 - 4 SOOW		
	Design Features			
	Impeller	2 vane enclosed		
Bearings	Ball bearing upper/lower			
Solid Passing	3 1/4"/79 mm (4" discharge), 4"/101 mm (6" discharge)			
Power Cord Length	25' (8 m) standard			
MOTOR	Motor Housing	304 stainless steel		
	Type	3 Ph		
	RPM	1400		
	Insulation Class	F		
	Motor Protection	Thermal sensor with automatic reset		
	Protection Class	IP68		
	Cooling	Oil-filled		
Maximum Fluid Temperature		40 °C (104 °F)		
Discharge Size		4" & 6"		



# Heavy Duty Solids-Handling Pumps

## PUMP PERFORMANCE CURVES, 2.8 - 10.0 KW

**64 HD Series**  
**4" flanged discharge**  
**High Head model**

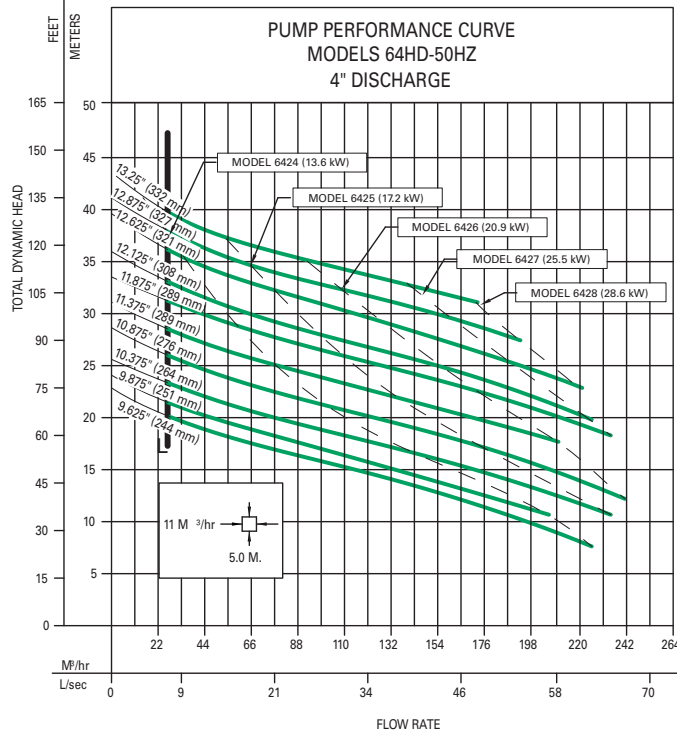

155422

**64 HD Series**  
**6" flanged discharge**  
**High Flow model**

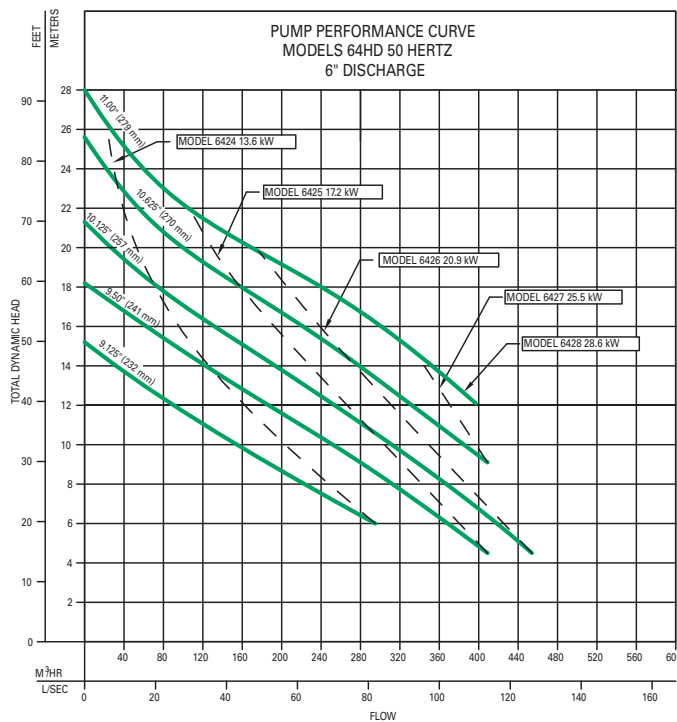

A00642

# Grinder Pumps

## 70 SERIES GRINDER, 1.0 - 2.0 KW

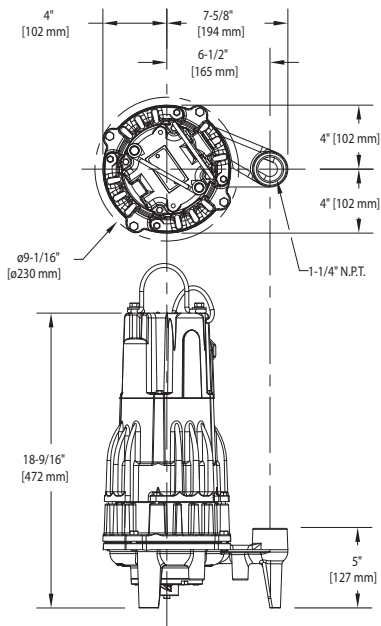

SK1621

### PUMP PERFORMANCE CURVES, MODELS 7008, 7009, 7010

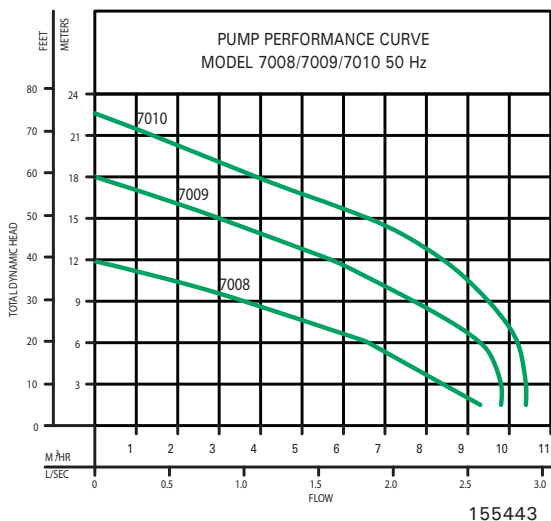

### 7008, 7009, 7010

Model	Double Seal	Mode	Volt	Ph	Amp	Motor		Weight	
						kW (p1)	Kg.	Lbs.	
V7008		Non	220	1	7.3	1.2	40	88	
AK7008		Non	380	3	3.1	1.1	40	88	
V7009		Non	220	1	8.7	1.6	40	88	
AK7009		Non	380	3	3.6	1.5	40	88	
V7010		Non	220	1	10.5	2.0	40	88	
AK7010		Non	380	3	3.9	1.8	40	88	

### APPLICATIONS:

- Low pressure sewer system
- High head sewage systems
- Municipal, commercial, and industrial

### FEATURES:

- Cast iron motor housing with powder coated epoxy finish
- Finned motor housing design provides greater heat dissipation
- Oil-filled motor

### OPTIONAL:

- Silicon carbide seals
- Additional cord lengths available in 11 m (35') or 15 m (50')

PUMP	Material	
	Pump Housing	Cast iron
Impeller	Engineered plastic	
Shaft Seal	Silicon carbide/carbon	
Seal and Gasket	Viton	
Power Cord	SOOW	
PUMP	Design Features	
	Impeller	Non-clogging vortex
Bearings	Ball bearing upper/lower	
Power Cord Length	6 m (20') standard	
MOTOR	Motor Housing	Cast iron
	Type	Capacitor start/capacitor run or 3 Ph
	RPM	2800
	Insulation Class	B
	Motor Protection	Auto reset thermal overload (1 Ph) or (3 Ph)
	Protection Class	IP68
	Cooling	Oil filled
Maximum Fluid Temperature	54 °C (130 °F)	
Discharge Size	1-1/4" NPT	
Maximum Submersion Depth	9 m (30')	
Hardware	Stainless steel	
Cutter/Cutter Plate	440C Stainless steel / Rockwell C55-60	



\*The color green is a registered trademark of Zoeller Pump Co.\*

# Grinder Pumps

## 70 SERIES GRINDER, 2.5 KW

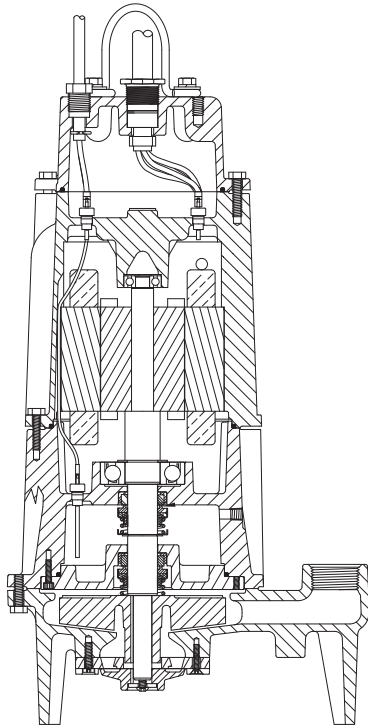

1-1/4" Vertical Discharge  
2.5 kW

ZEPA0374

## PUMP PERFORMANCE CURVES, 2.5 KW

**Models 7011, 7012, 7013**  
reversing and single  
direction

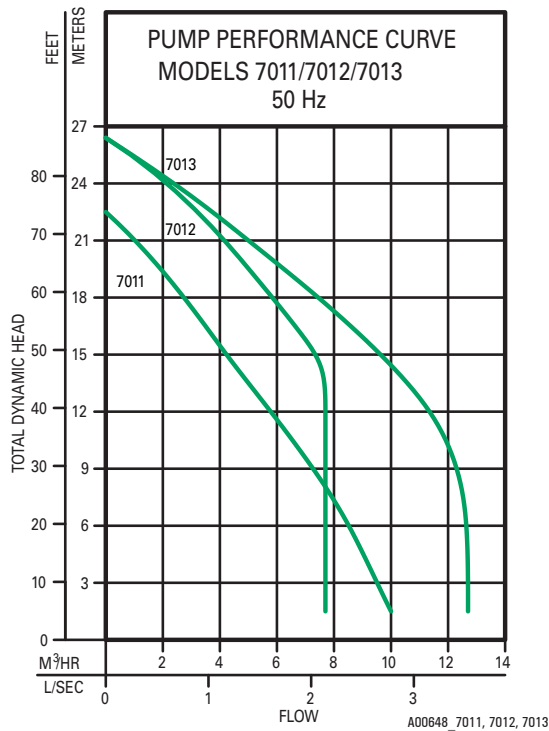

### APPLICATIONS:

- Pump stations
- Housing developments
- Pressure sewers

### FEATURES:

- Cast iron support legs for free-standing applications
- Stainless steel lifting bail
- Protective cutter ring helps extend cutter life
- Cast iron construction with corrosion-resistant, baked-on epoxy powder coating
- Patented moisture-detection system with upper and lower probes
- Concentric pump housing with centerline discharge reduces radial loading

### OPTIONAL:

- Silicon carbide seals
- Trimmed impeller
- Bronze impeller (7011 and 7013)
- Certified tests
- Additional cord lengths available in 11 m (35') or 15 m (50')
- CE rated models include a 10 m (33') cord

## 70 Series

Model	Mode	Volt	Ph	Amp	Motor		Weight	
					kW (p1)	Kg.	Lbs.	
V7011	Non	220	1	12.0	2.8	60	132	
AK7011	Non	380	3	4.4	2.5	60	132	
V7012	Non	220	1	12.0	2.8	62	137	
AK7012	Non	380	3	4.4	2.5	62	137	
V7013	Non	220	1	12.0	2.8	62	137	
AK7013	Non	380	3	4.4	2.5	62	137	

Material		
PUMP	Pump Housing	Cast iron
	Impeller	Ductile iron - 7011, 7013; Bronze - 7012
	Shaft Seal	Silicon carbide/carbon lower, carbon/ceramic upper
	Seal and Gasket	Viton
	Power Cord	14 AWG SOOW (H07RN-F4G1.5 for CE models)
	Design Features	
MOTOR	Impeller	Non-clogging vortex
	Bearings	Ball bearing upper/lower
	Power Cord Length	6 m (20') standard (10 m [33'] on CE models)
	Motor Housing	Cast iron
	Type	3 Ph and cap start/cap run for 1 Ph
	RPM	2800
	Insulation Class	F
	Motor Protection	Thermal overload with automatic reset (1 Ph) Thermal sensor with automatic reset (3 Ph)
Protection Class	IP68	
Cooling	Oil filled	
<b>Maximum Fluid Temperature</b>		40 °C (104 °F)
<b>Discharge Size</b>		1-1/4" NPT
<b>Hardware</b>		Stainless steel
<b>Cutter/Cutter Plate</b>		Stainless steel / Rockwell C55-60



# Grinder Pumps

## MODEL 7021 2 HP - PROGRESSIVE CAVITY GRINDER



### FEATURES:

- Progressive cavity grinder pump with a hardened, stainless steel cutter and cutter plate
- Stainless steel mounting stand for free-standing installation
- Cast iron motor housing with powder coated epoxy finish
- Finned motor housing design provides great heat dissipation
- 1-1/4" NPT and BSPT horizontal discharge
- Construction - Motor housing, cover, adapter and pump housing cast iron ASTM A-48, Class 30, 30,000# tensile strength, corrosion-resistant, powder coated epoxy finish
- Viton square rings and gasket
- Stainless steel cutter and plate hardened to Rockwell C 55-60
- Pressure relief valve
- Stainless steel legs provide for free-standing installation
- Stainless steel helix hydraulic rotor
- Buna-N hydraulic stator
- 230 V / 1 Ph, 1400 RPM, 2 HP
- Housing - Finned cast iron, oil-filled

### APPLICATIONS:

- Low pressure sewer systems
- High head sewage systems
- Residential and commercial

### OPTIONAL:

- Available with a CE rated 10m (33') H07RN cord, sensor cord and no molded plug



## PUMP PERFORMANCE CURVE, 2.5 KW

### Model 7021

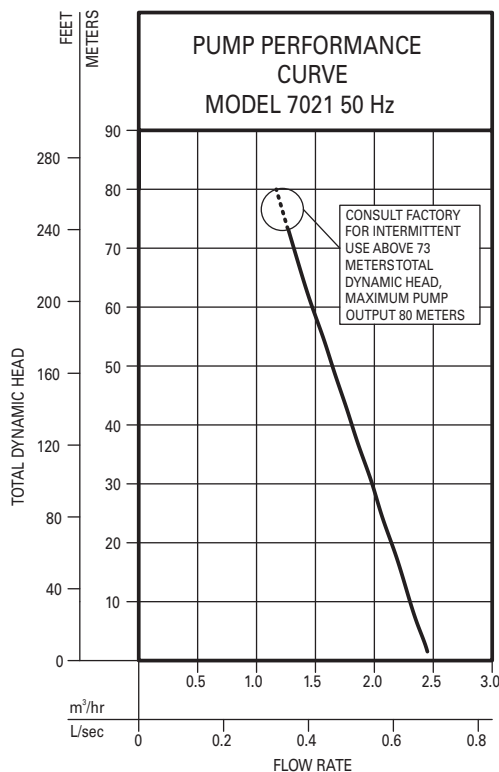

Model	Mode	Volt	Ph	Amp	Motor		Weight	
					kW (p1)	HP	kg.	Lbs.
Z7021	Non	230	1	8.5	1.5	2	41	91

	Material	
	<b>PUMP</b>	Pump Housing
Impeller		Stainless steel
Shaft Seal		Carbon and ceramic
Seal		Neoprene
Bearings		High carbon chrome steel
Power Cord		SOW/SOOW (CE model H07RN-F)
<b>MOTOR</b>	Design Features	
	Impeller	Helical
	Bearings	Ball bearing upper/lower
	Power Cord Length	10 m (33') standard
	Motor Housing	Cast iron
	Type	Permanent split capacitor
	RPM	1400
	Rotor	AISI 416 stainless steel
	Insulation Class	B
	Motor Protection	Auto reset thermal overload (1 Ph)
Protection Class	IP68	
Cooling	Oil filled	
<b>Maximum Fluid Temperature</b>		40 °C (104 °F)
<b>Discharge Size</b>		1-1/4" NPT
<b>Max. Submersion Depth</b>		6 m (20')
<b>Hardware</b>		Stainless steel
<b>Cutter/Cutter Plate</b>		440C Stainless steel/RockWell C 55-60



NSF / ANSI 46

# Grinder Pumps

## 71 SERIES GRINDER, 3.2 - 5.3 KW

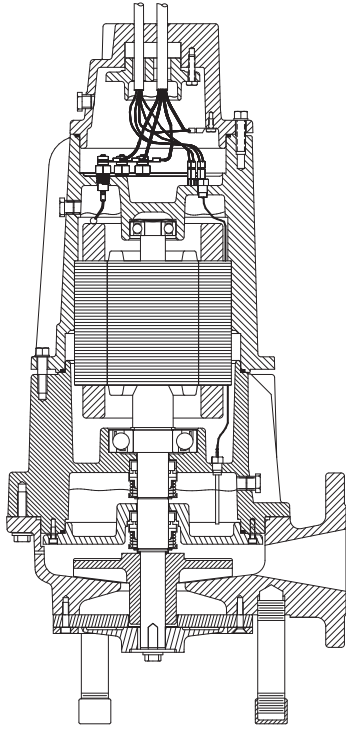

ZEPA0483B

Flanged Horizontal Discharge  
2-1/2" adaptable to 3"  
3.2 - 5.3 kW

### APPLICATIONS:

- Sewage lift stations
- Housing developments
- Low pressure sewer systems
- High vertical lift or long force mains

### FEATURES:

- Protected cable entrance with compression grommet that allows for field replacement of cable
- Individually sealed conductors for elimination of cord wicking liquids
- Lifting lug integral part of housing
- Thermal sensor and moisture detection system with upper and lower probes
- Cast iron construction with corrosion-resistant, baked-on epoxy powder coating

### OPTIONAL:

- High Flow (HF) or High Head (HH) models
- Reversing (Rev) models (3 Ph flanged models only)
- 2" NPT vertical discharge (HH and HF Units only)
- Silicon carbide seals
- Trimmed impeller
- Certified tests
- Additional cord lengths available in 15 m (50') or 23 m (75')
- CE rated models include a 10 m (33') cord

## 71 HD Series

Model	Double Seal	Mode	Volt	Ph	Amp	Motor		Weight	
						kW (p1)	Kg.	Lbs.	
AK7110		Non	380	3	6.2	3.2	111	245	
AK7111		Non	380	3	7.7	4.3	111	245	
AK7112		Non	380	3	9.5	5.3	111	245	

		Material		
PUMP	Pump Housing	Cast iron		
	Impeller	Ductile iron		
	Shaft Seal	Silicon carbide/carbon lower, carbon/ceramic upper		
	Seal and gasket	Buna-N		
	Power Cord	SOOW (H07RN-F4G4 for CE models)		
	<b>Design Features</b>			
	Impeller	Non-clogging vortex		
Bearings	Ball bearing upper/lower			
Power Cord Length	7.6 m (25')			
MOTOR	Motor Housing	Cast iron		
	Type	3 Ph		
	RPM	2800		
	Insulation Class	F		
	Motor Protection	Thermal sensor with automatic reset		
	Protection Class	IP68		
	Cooling	Oil filled		
<b>Maximum Fluid Temperature</b>		40 °C (104 °F)		
<b>Discharge Size</b>		2-1/2" flanged horizontal adaptable to 3" or 2" NPT vertical		
<b>Hardware</b>		Stainless steel		
<b>Cutter/Cutter Plate</b>		Stainless steel/ Rockwell C55-60		



\*The color green is a registered trademark of Zoeller Pump Co.\*

# Grinder Pumps

## PUMP PERFORMANCE CURVES, 3.2 - 5.3 KW

**71 Series High Head Grinder**  
**2-1/2" flanged or 2" NPT Discharge**  
**3.2, 4.3, 5.3 KW**

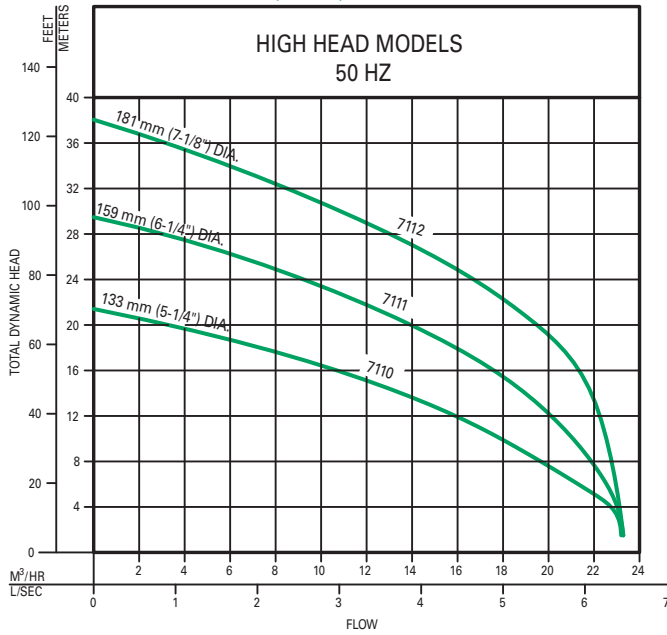

A00645

**71 Series Reversing Grinder**  
**2-1/2" flanged discharge**  
**3.2, 4.3, 5.3 KW**

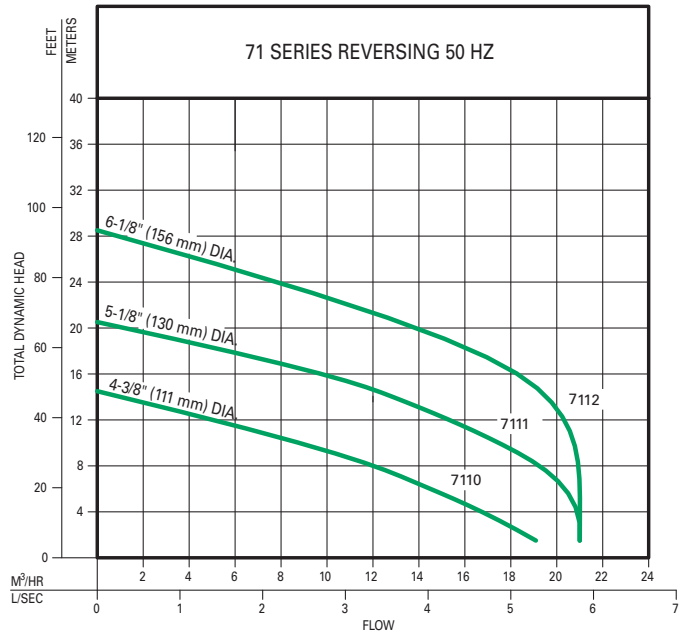

A00674

**71 Series High Flow Grinder**  
**2-1/2" flanged or 2" NPT Discharge**  
**3.2, 4.3, 5.3 KW**

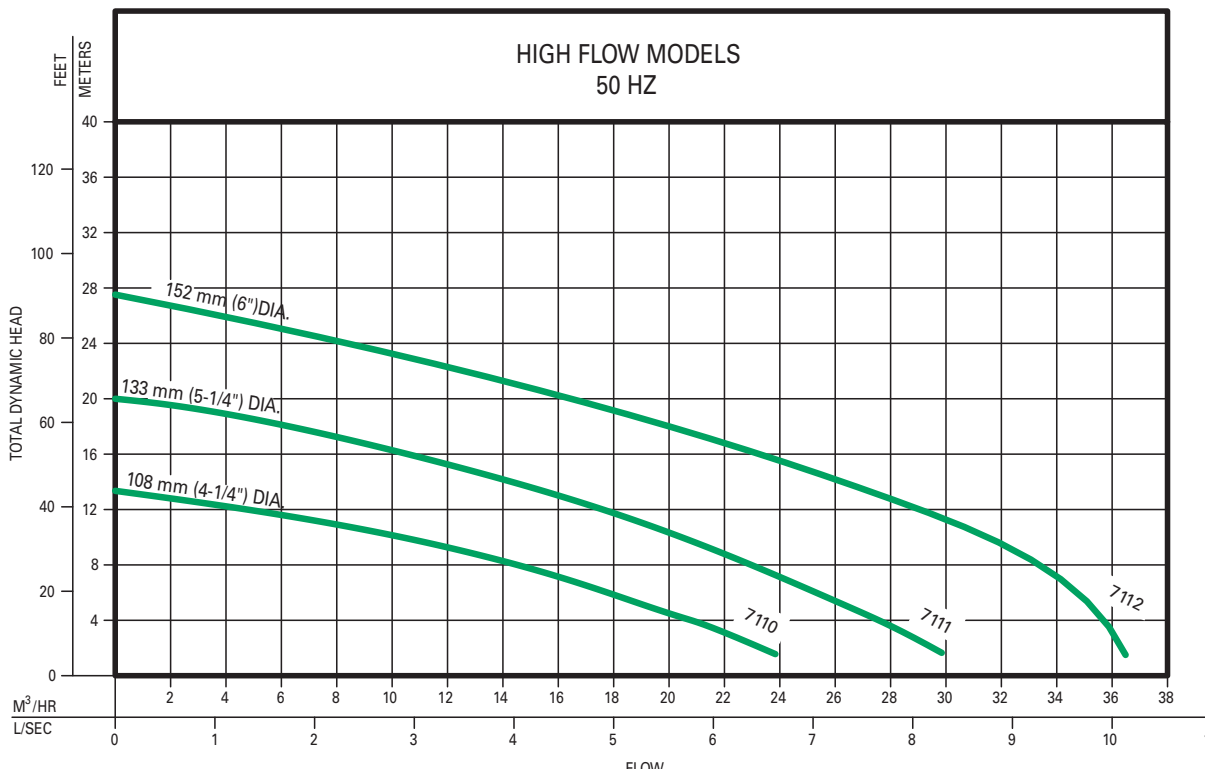

A00673



# Lift Station Accessories

## Standard Control Panel

### Features:

- Simplex and duplex configurations
- NEMA 4X outdoor rating
- Lockable hasp
- Pump disconnect
- Motor contactor
- 115 Volt control circuit
- Pilot lights and selection switches
- High water alarm circuits with dry contacts
- Seal leak indication
- Thermal cut-out circuit
- Reversing circuits for 7011 and 71 Series Reversing Grinder pumps

### Options:

- Inner door
- Elapsed time meter(s)
- Event counter(s)
- Alarm flasher
- Lightning arrester/surge suppressor
- Anti-condensation heater
- Redundant off circuit

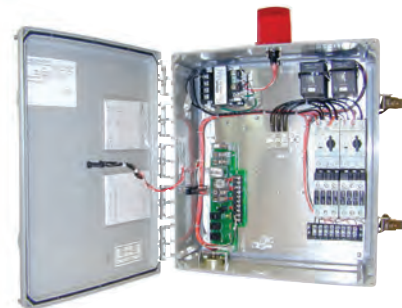

Custom panel designs available by request

## 1-1/4" - 3" Threaded "Full-Flow" Unichecks

- Vertical or horizontal installation
- Full flow design - no restrictions
- Standard, 1-1/4", 1-1/2", 2", 3" female NPT pipe
- Neoprene polyester reinforced flapper - smooth edge design with cast iron, non-corrosive metal backing plates and stainless steel fastener
- Rated at 345 kPa (50 PSI) (35 m [115'] of head) at 54 °C (130 °F)
- Cast iron body and stainless steel bolts
- Corrosion-resistant, powder coated epoxy finish



## 2-1/2" - 8" Flanged Check Valves for Sewage or Dewatering Applications

- Heavy-duty cast iron construction
- Angled seal for non-slam closure
- Non-clog design
- Reinforced disc
- Drip-tight seating
- Rated up to 200 psig
- Designed for both horizontal and vertical use



## 1-1/4" - 3" PVC BALL VALVES

- General purpose ball valve
- Ideal for a variety of applications
- 150 PSI Rated



## 2" - 8" Cast Iron Plug Valves Threaded Connection - 2" and 3" Flanged Connection - 2-1/2", 3", 4", 6", 8"

- Designed to handle solids-bearing flows
- Cast iron housing - rated 1,207 kPa (175 PSI)
- 99% pure nickel welded seat
- 1/4 turn Buna plug
- Upper and lower ball bearings
- Provided with hand lever



## 1-1/4" & 2" BRONZE CHECK VALVES

- All bronze construction
- Metal to metal seals
- 150 PSI rated
- Vertical or horizontal installation
- Stops back flow of water
- Suitable for installation below basin cover



## 1-1/4" & 2" BRONZE BALL VALVES

- All bronze construction
- 150 PSI rated



## Z-Rail Disconnect System (1-1/4", 1-1/2", 2")

- Cast iron construction with corrosion-resistant, baked-on epoxy powder coating
- Robust construction, designed to support a 136 kg (300 lb.) pump
- Provides for an easy pump install or removal operation with no need for personnel to enter basin
- Compact design for small spaces
- Adaptable to most 1-1/4", 1-1/2" and 2" pumps with a vertical NPT discharge
- 1-1/4" horizontal NPT discharge available for progressing cavity grinder pumps
- Grooved, machined fit for a positive seated rail plate
- O-ring seals prevent leakage
- Uses 3/4" IPS guide rails
- Intermediate stabilizer for pits over 3.7 m (12') deep
- Tested to seat at heads up to 1,103 kPa (160 PSI) (113 m [370'] TDH)

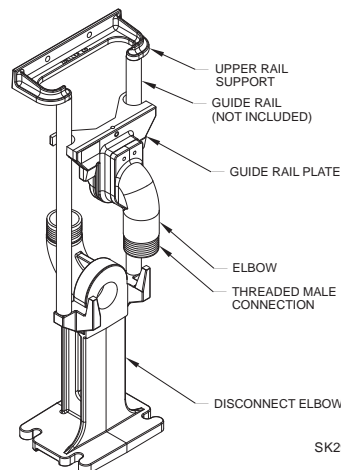

SK2976

# Guide Rail Systems

## Guide Rail Systems (3", 4" & 6" discharge)

- Automatic engagement and easy disengagement
- Ductile iron fittings (3" vertical) or Class 30 cast iron fittings (3", 4" & 6" flanged)
- Enamel-coated (3" vertical) or epoxy coated casting (3", 4" & 6" flanged) discharge
- Supports pump
- Use 3/4" IPS (3" vertical) or 2" IPS (3", 4" & 6" flanged) guide rails. Brass, stainless steel or galvanized steel pipes recommended (not furnished).
- Intermediate stabilizers for pits over 3.7 m (12') (3" vertical) or 4.6 m (15') (3", 4" & 6" flanged) deep



3" NPT Systems



4" & 6" Systems



2-1/2" & 3" Horizontal Flanged

Products may not be exactly as pictured

## 3", 4" & 6" FLYGT Guide Rail System Adapters

Adapter plates for retrofitting 3", 4" & 6" horizontal discharge pumps to existing Flygt rail systems.

- Cast iron construction
- Flange conforms to ANSI B16.10 fully flat/MSS SP-6
- For use with all pumps with 3", 4" or 6" horizontal discharges and 2" NPT rail pipe
- Flange gasket and stainless steel bolts included

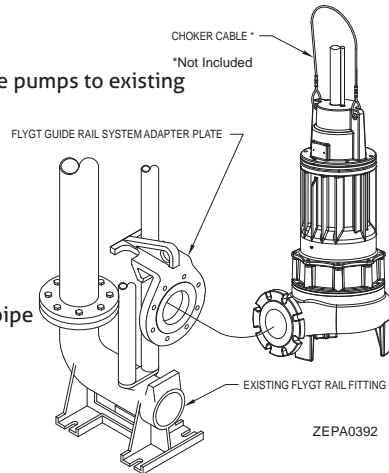

## 4" X 6" Flanged Dry Pit Mounting Stand With Clean-Out

- Class 30 epoxy coated cast iron construction
- 6" inlet / 4" outlet
- Flanges conform to ANSI B16.10 fully flat/MSS SP-6
- For use on Dry-Pit pumps with 4" discharge
- 3" clean out plug

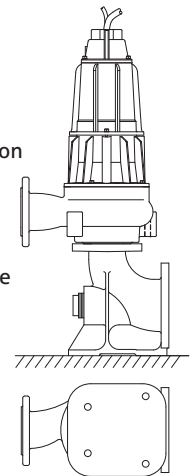

## Engineered Lift Stations

- Factory assembled for job ready installation
- Built to specification and/or job requirements
- Fiberglass basins up to 244 cm (96") diameter and 610 cm (240") depth
- Steel and aluminum hatched access covers
- 7.6 m - 15.2 cm (3" - 6") rail systems and discharge piping
- PVC, galvanized and stainless steel discharge piping
- Check valves and ball or plug valves
- Optional attached valve box

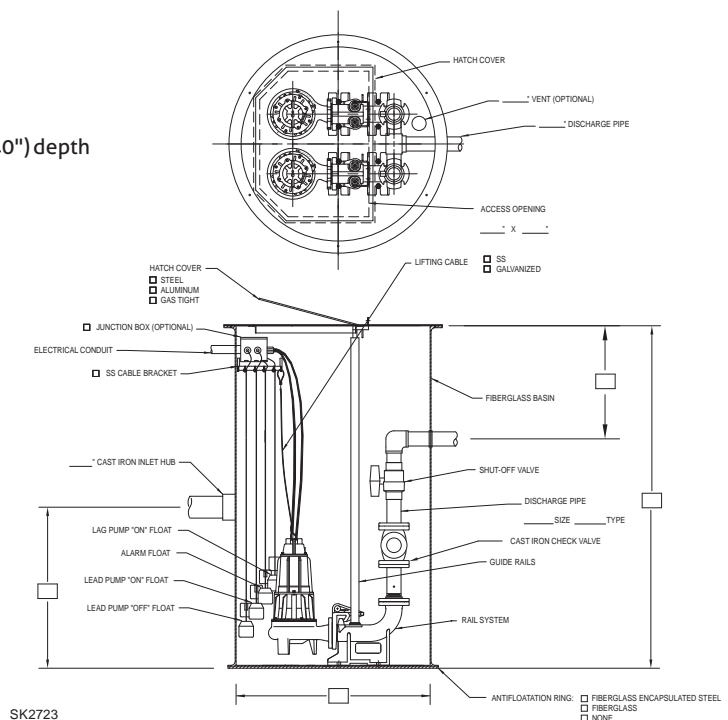

# Professionals Training Professionals



The Center For Excellence training facility at Zoeller Company in Louisville, Kentucky offers a unique opportunity to experience the pump industry, learning from experts in the field. Bring your customers for an hour, a day, or more. Learn about the pump industry and why Zoeller products are designed to be the best for professionals.

## What We Do

Gain first-hand experience in the unique and varied aspects of pump manufacturing and specification at our 6,000 ft<sup>2</sup> facility. In the demonstration room, our industry professionals offer live demonstrations and computer simulations of our latest products and core concepts. Lift stations including active controls are designed to demonstrate the how-and-why of pump technology. A state-of-the-art classroom provides space for lectures and group discussions with a library of cutaway models for reference.

## Training Tailored To Meet Your Needs

Training experiences at the CFE are tailored to cover the specific topics that most interest you and your customers. All participants gain valuable technical and practical product knowledge. Our training staff will work with you to design the most profitable experience for your group. Some topics we have covered to date include:

Pump sizing

Troubleshooting a control panel

Product overview

Startup training

How performance curves are created

Rail systems



Email us! [cfetraining@zoeller.com](mailto:cfetraining@zoeller.com)



ZM2846\_Eb

0422

Supersedes

0420

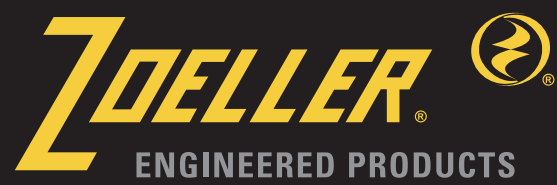

3649 Cane Run Road • Louisville, KY 40211 • 502-778-2731 • 1-800-928-7867 • [zoellerengineered.com](http://zoellerengineered.com)